

CYCLONE POLISHING DRUM WHEELS 3/4"



DETAILS

- Small diameter allows you to wet polish tight radiuses not accessible with a pad
- Dual threaded adapter allows for use on CNC or hand-held water fed polisher
- Available in 7 grits that change out easily from the stainless steel adapter
- Wet use only

Item #	Grit	Size (WxL)	Dual Fitting	RPM
SRD250	50	3/4 x 1 1/2	1/2 gas & 5/8-11	3,000
SRD2100	100	3/4 x 1 1/2	1/2 gas & 5/8-11	3,000
SRD2200	200	3/4 x 1 1/2	1/2 gas & 5/8-11	3,000
SRD2400	400	3/4 x 1 1/2	1/2 gas & 5/8-11	3,000
SRD2800	800	3/4 x 1 1/2	1/2 gas & 5/8-11	3,000
SRD21500	1500	3/4 x 1 1/2	1/2 gas & 5/8-11	3,000
SRD23000	3000	3/4 x 1 1/2	1/2 gas & 5/8-11	3,000
SRDAPT		4" adapter length	5/8" Inner thread + 1/2" gas outer	

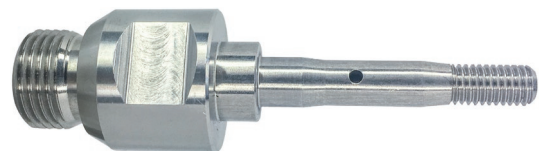

Tools:



Material:



Granite



Engineered Stone

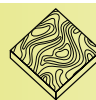

Marble

